









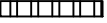

Outdoor sectorial  
Crear punto

Elaborado por: Área de Servicios Tecnológicos

# PLANTA 2

## CONVENCIONES

-  PISO
-  TUBERIA EMT
-  PROYECCIÓN ESCALERILLA  
PORTA CABLES RECORRIDO  
HORIZONTAL
-  PROYECCIÓN MALLA PORTA  
CABLES RECORRIDO  
HORIZONTAL
-  DATOS
-  VOZ
-  RACK
-  BAJANTE
-  CAJA DE PASO 10X10 DOBLE  
FONDO
-  CANALETA

TUBERIA PVC EMPOTRADA EN

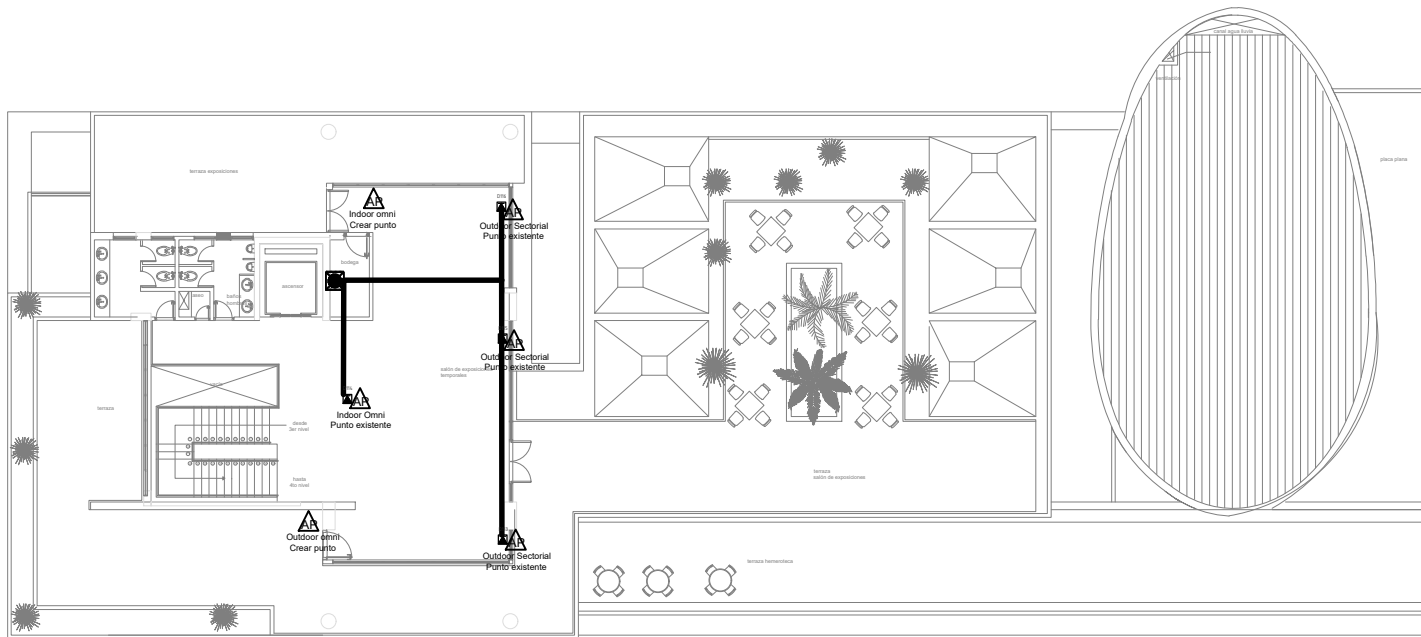

Elaborado por: Área de Servicios Tecnológicos

# PLANTA 3

## CONVENCIONES



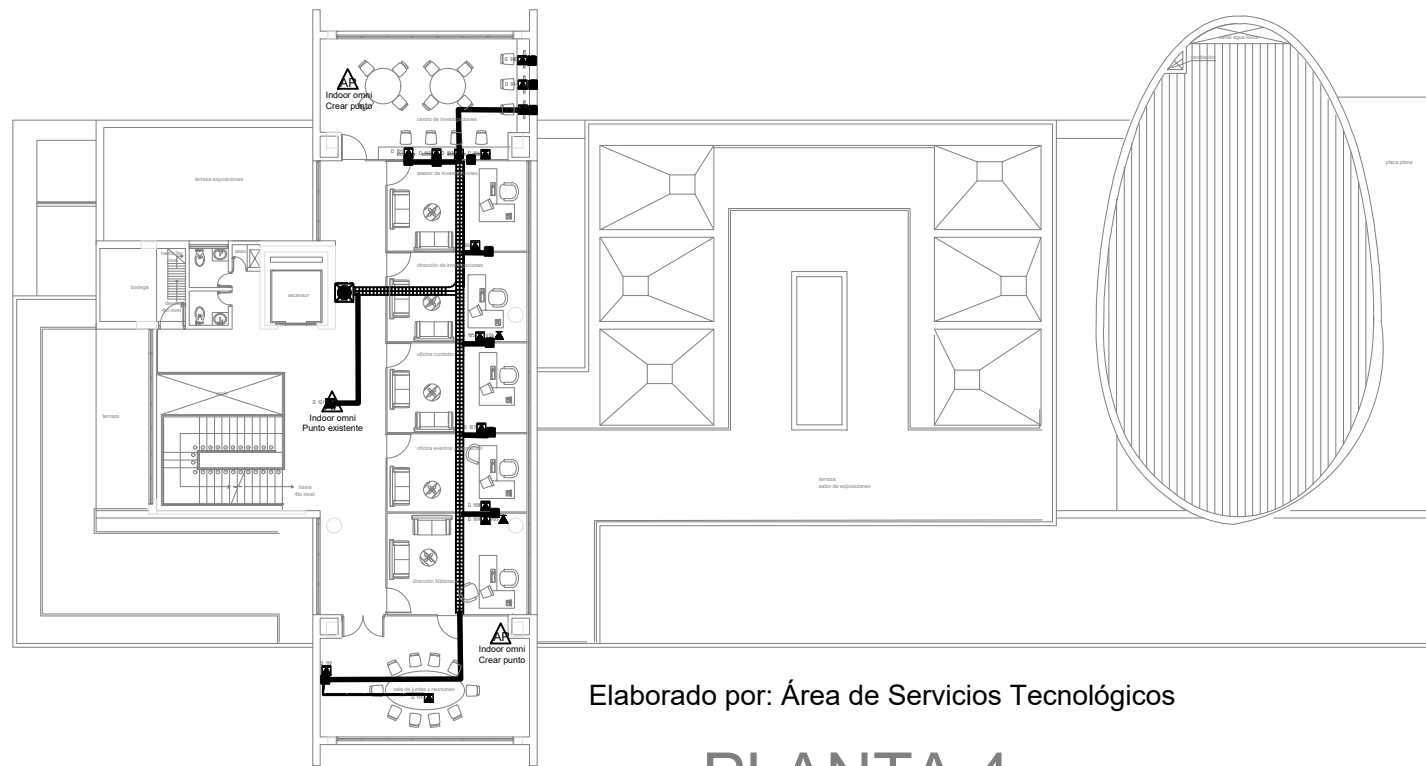



-  TUBERIA PVC EMPOTRADA EN PISO
-  TUBERIA EMT
-  PROYECCIÓN ESCALERILLA PORTA CABLES RECORRIDO HORIZONTAL
-  PROYECCIÓN MALLA PORTA CABLES RECORRIDO HORIZONTAL
-  DATOS
-  VOZ
-  RACK
-  BAJANTE
-  CAJA DE PASO 10X10 DOBLE FONDO
-  CANALETA



Elaborado por: Área de Servicios Tecnológicos

# PLANTA 4

## CONVENCIONES

-  TUBERIA PVC EMPOTRADA EN PISO
-  TUBERIA EMT
-  PROYECCIÓN ESCALERILLA PORTA CABLES RECORRIDO HORIZONTAL
-  PROYECCIÓN MALLA PORTA CABLES RECORRIDO HORIZONTAL
-  DATOS
-  VOZ
-  RACK
-  BAJANTE
-  CAJA DE PASO 10X10 DOBLE FONDO
-  CANALETA